



# Datasheet

## RS PRO Rack Mount enclosure

Stock number: 188-1346

EN



The PF-19 Series of rack mounted 19" Enclosures, like its companion SA Series, is designed for both the industrial and home hobbyists. PF-19 is a heavy duty enclosure which can be installed into any standard 19" rack or using the rubber feet provided, set on any surface. The high quality steel body features removable top and bottom panels, which are liberally vented so your components stay cool. The 3.00 mm thick Aluminum front panel is stout but easily worked by the user. Inside front steel plate and multi holed mounting rails, allow for convenient PCB and component installation.

## Features

- Light weight and strong
- Easy to assemble
- Extensive top/bottom and side/side ventilation
- Inner front panel for component mounting allows outer front panel to remain “clean” appearance.
- Optional mounting plates for PCB and heavy components such as transformers
- 19” rack mounted or free standing
- Flat pack for efficient storage and shipping

## Standards and Materials

- Heights from 1U to 6U
- Depths of 245mm, 335mm and 425mm
- Dimensions conform to IEC-60297-3
- Premium grade Cold Rolled Steel
- Designed and manufactured under ISO 9001:2015 and ISO 14001:2015
- All materials RoHS compliant.



Item	Description	Material	QTY
1	Top Base Cover	Mild Steel 1.20 mm.	2
2	General Purpose Bar	Zinc Plate Steel 1.20 mm.	8
3	Inside Front/Back Panel	AL 1.50 mm.	2
4	Side Panel	Mild Steel 0.90 mm.	2
5	Front Panel	AL 3.00 mm.	1
6	Handle	AL Extruded	2
7	Screw M3x6 mm. Pan Head Black (with washer)	Steel	16
8	Taper Screw M3 x 12	Steel	12
9	Hex Nut M3 x 0.50 Black	Steel	12
10	Hex Socket Screw M5 x 20	Steel	4
11	Rubber Foot	Rubber	4
12	Screw M4x8 mm. Pan Head Black [with washer]	Steel	16
13	Hex Nut M5 BLK.	Steel	4

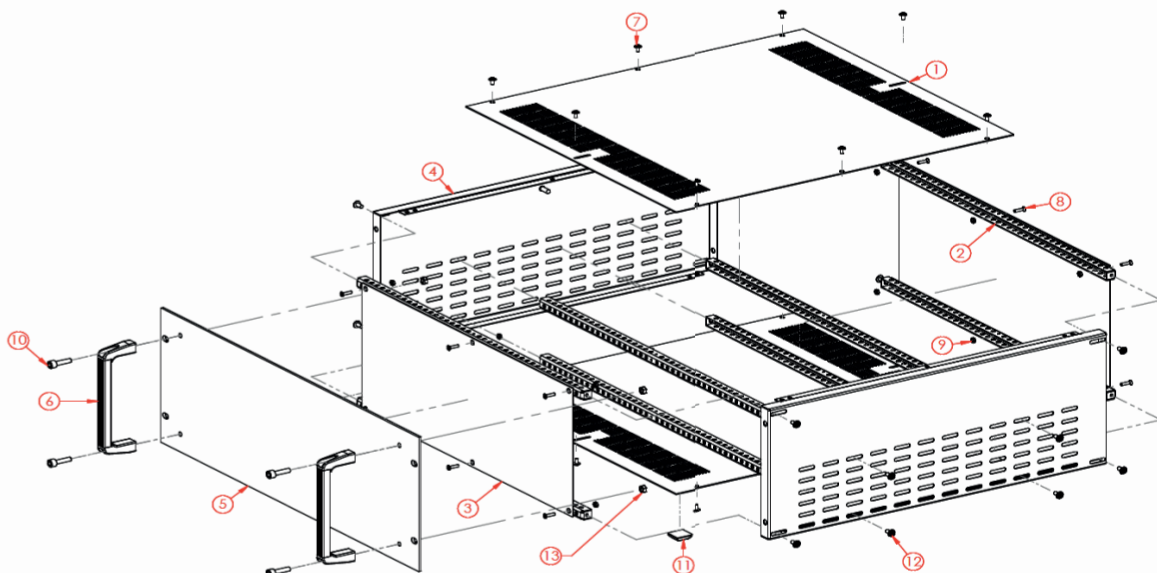

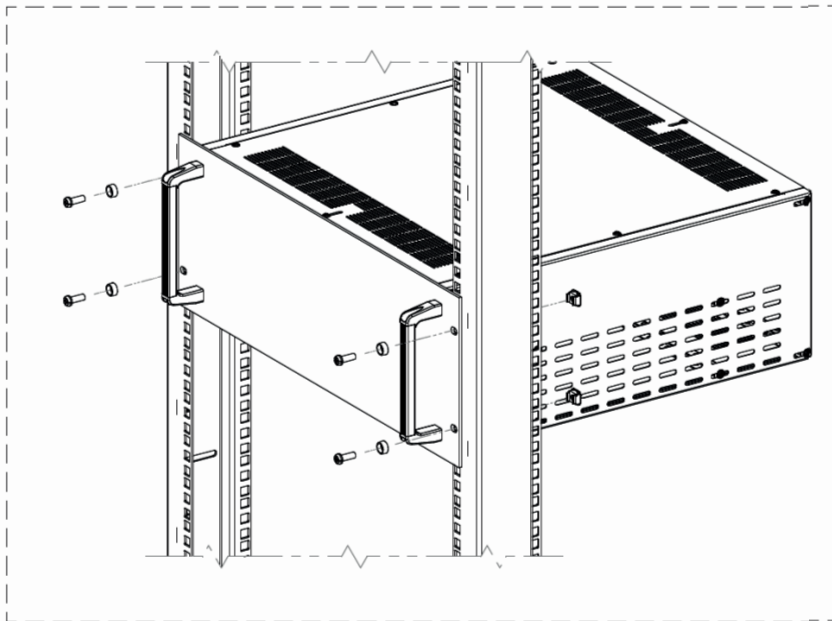
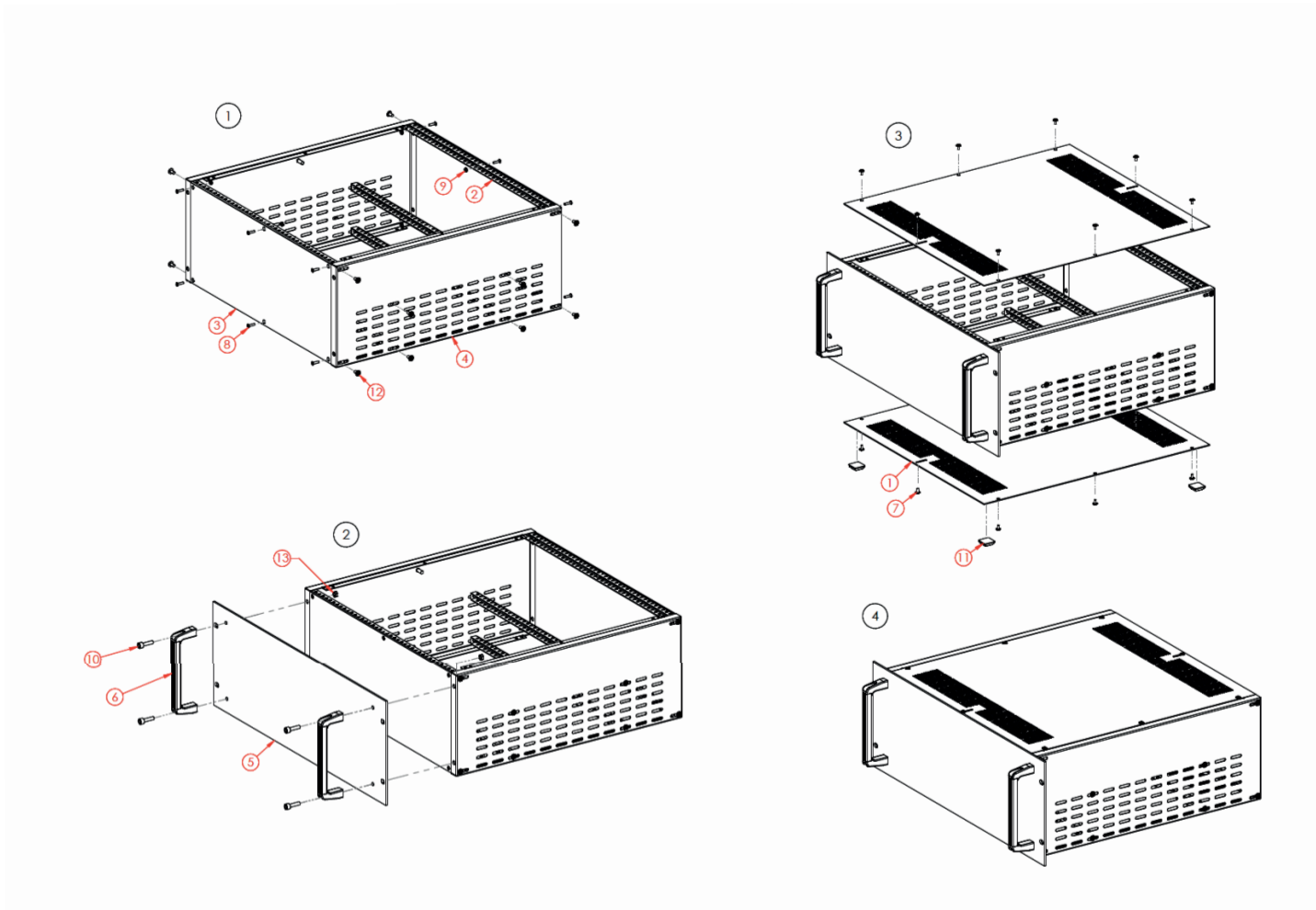

## Specifications

Attribute	Value
Product 188-1346	Rack Mount 3U-335D
External Width	425mm
External Depth	335mm
External Height	127.60mm
External Dimensions	425 x 335 x 127.60
Body Material	Mild steel
IP Rating	IP30
Color	Black
Lid Color	Black
Flanged	No
Shielded	No
Gasket Material	No
Standard Met	ROHs Compliant
Application	Electrical, Electronic, Industrial