

**Unless otherwise specifically requested, the strips will be delivered either in solid or breakable plastic depending on availability of the insulator bodies.**

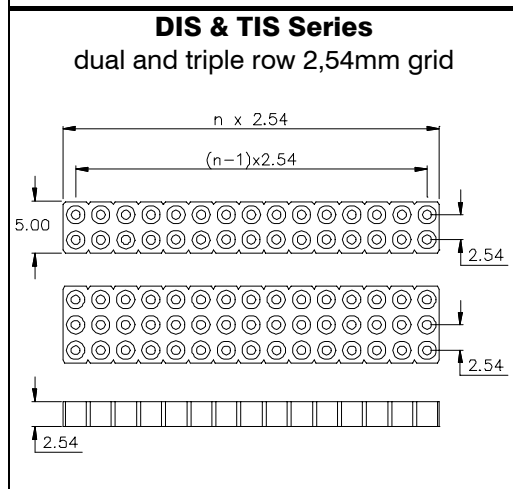

**SIB Series**  
**SIB-1xx-Sxxx-xx**  
Number of contacts standard breakable available  
**20; 32 and 40**

Number of contacts either breakable or solid available  
**02 to 40**

**DIS Series**  
**DIS-2xx-Sxxx-xx**  
Number of contacts available from **04 to 80**

**TIS Series**  
**TIS-3xx-Exxx-xx**  
Number of contacts available from **06 to 96**

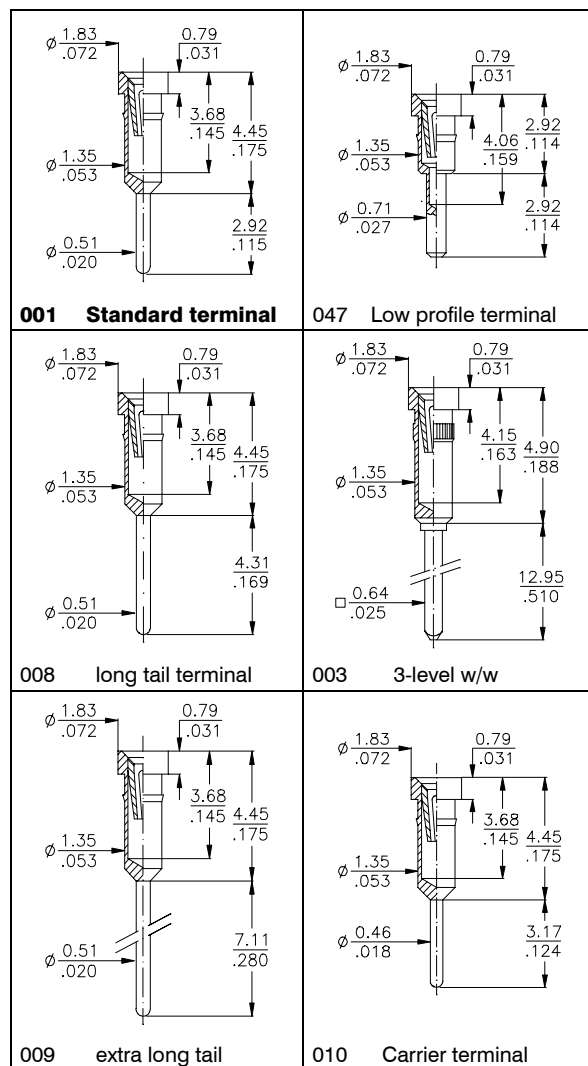

**Strips**  
Other lengths & pin-outs available on request.

**Specifications**  
See page 71 of this catalogue

**Terminals**  
For other terminal styles please refer to the last pages of this catalogue or contact your closest sales office.

## How to order

XXX - xxx - X xxx - xx

Series	Rows	Nbr of contacts	Insulator	Terminal style	Plating
<b>SIB</b> = single-in-line strips	..... <b>1</b>	see above table	<b>S</b> = Plastic <b>E</b> = Epoxy FR4 TIS Series only	see drawings above or refer to last pages of this catalogue for other types.	<b>- 01</b> = tin/gold
<b>DIS</b> = dual-in-line strips...	..... <b>2</b>				<b>- 11</b> = gold/gold
<b>TIS</b> = triple-in-line strips...	..... <b>3</b>				<b>- 00</b> = tin/tin

# SIB/DIS/TIS Series - Adapter Strips

2,54mm pitch



Board to Board Terminals		
<p>077</p>	<p>057</p>	<p>037</p>
<p>058</p>	<p>059</p>	<p>056</p>
<p>542</p>	<p>038</p>	<p>353</p>
<p>036</p>	<p><b>Many other terminals &amp; custom specific terminal styles are available on request, or see the last pages of this catalogue.</b></p>	

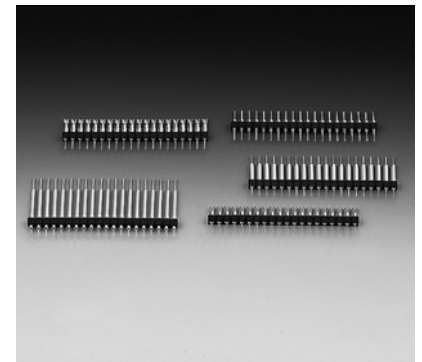

<p><b>Application Examples</b></p>
<p><b>Possible Terminals:</b></p> <p>037; 056; 057; 058; 059; 077 220; 221; 542; 543; 544; 562 770;</p>
<p><b>Possible Terminals:</b></p> <p>037; 056; 057; 058; 059; 077 542; 544; 562; 770</p>

How to order

XXX - x xx - X xxx - xx

Series	Rows	Nbr of contacts	Insulator	Terminal style	Plating
SIB = single-in-line strips.	.....1		S = Plastic	see drawings above or refer to last pages of this catalogue for other types.	- 22 = gold
DIS = dual-in-line strips...	.....2	see socket strip page.	E = Epoxy FR4 (TIS Series only)		- 00 = tin
TIS = triple-in-line strips..	.....3				

## General Specifications for Precision Pin Sockets

### Mechanical data

Average forces for available clip types:

Standard type	1.80N insertion / 0.90N extraction
Low force type	0.70N insertion / 0.25N extraction
Super low force type	0.40N insertion / 0.15N extraction
High force type	4.00N insertion / 2.50N extraction
„Jumbo“ contact	1.40N insertion / 0.25N extraction

Other clips and forces available on request

Contact life	min. 100 cycles
Solder ability	exceeds MIL-STD-202 Method 208
Water absorption during 24hrs at 20°C PBT / PPS	0.05%
FR4 Epoxy	0.15%

**Operating temperature** (standard) -65°C to +150°C

### Soldering temperature

Standard PBT	+175°C min. for 10 sec.
Hi-temp PPS, LCP	+260°C min. for 10 sec
Epoxy FR4	+220°C min. for 10 sec..

### Electrical data

Contact resistance at 1A	4,3 mΩ typ.
Current rating (except „Jumbo“ contact)	1A max.
„Jumbo“ contact	3A max.
Contact capacitance at 1MHz	2pF max.
Insulation resistance at 500V DC for std & hi-temp	5 × 10 <sup>9</sup> Ω min.
Insulation resistance at 500V DC for FR4 Epoxy	> 10 <sup>4</sup> MΩ
Breakdown voltage at 60 Hz	500 V AC min.
Contact resistance after 1000 ins./ext. cycles	≤ 7 mΩ

### Material

Standard insulator	Glass filled polyester UL 94 V-O
Hi-temp insulator	PPS, UL 94 V-O
Epoxy insulator	Glass Epoxy FR 4, UL 94 V-O
Terminal	CuZn
Contact	BeCu

### Male pin dimensions for standard clip ( except „Jumbo Contact“ )

( DIN 41 870, IEC 191 for square IC-legs )

DIM	min.	max.
„A“ ∅	<u>0.42</u> .016"	<u>0.56</u> .022"
„B“ □	<u>0.36</u> .014"	<u>0.55</u> .023"
„C“ □	<u>0.20</u> .008"	<u>0.30</u> .014"

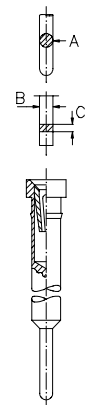

## General information concerning the E-tec interconnect products

### Plating:

Standard tin plating:  
Min. 4,00μm SnPb (90/10) over min. 1,30μm Ni

Standard gold plating:  
flash, max. 0,10μm Au over min. 1,30μm Ni  
Higher gold platings are offered on request

### Specifications:

The data contained in this catalog is of general nature and refers to standard products. For example a „Current rating“ at an ambient temperature of 25° C reflects the value per individual contact. Should you require any further data or test reports, you can obtain this information from your nearest E-tec sales office.

The E-tec connectors conform with signal integrity requirements at high data and frequency rates. However we cannot offer a general information about the max. frequency or data transmission rate. For such a statement, it would require more information about the chosen configuration and pin-out, the length of the cable and/or any other specific requirements regarding the application itself and its related signal integrity.

E-tec SMT connectors, male or female, are offered with a coplanarity of max. 0,10mm

They are adapted to all modern SMT soldering processes and they can be handled easily with all currently existing placing techniques. Customers may choose between various packaging options, such as tray, tube and tape & reel.

## GENERAL POLICY

All information contained in this catalog, including illustrations, specifications and dimensions are accurate to the best of our knowledge, and reflect the status as at the date of publication. Due to technical progress, it is subject to change without notice. Application information is informational in nature and shall not be construed to warrant suitability of products for any particular purpose as performance may vary with the conditions encountered. Unless otherwise confirmed at the time of order. All E-tec products are non cancellable - non returnable items (NCNR). E-tec's products are warranted for 30 days and the warranty is limited strictly to replacement of products with defective workmanship.